



Karta produktu

Data sheet / Produktkarte

Profil LED

Profile LED / LED-Profil

**IPA 12/
IPA 16**

**APA 12/
APA 16**

APA 12

APA 16

IPA 12

IPA 16

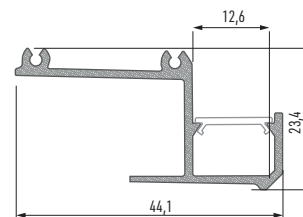
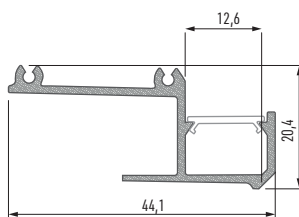
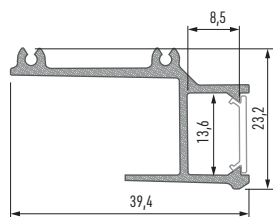
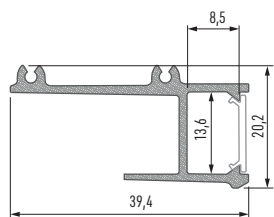

Profil LED APA i IPA Profile LED APA and IPA / LED-Profil APA und IPA

	BIAŁY (lakierowany) white (lacquered) / weiß (lackiert)	SREBRNY (anodowany) silver (anodized) / silber (eloxiert)
APA 12		
APA 16		
IPA 12		
IPA 16		
Wymiary (mm) Dimensions / Abmessungen	1000 mm, 2020 mm, 3000 mm	
Szerokość taśmy LED (mm) LED strip width / LED-Streifen Breite	do 12 mm up to 12 mm / bis 12 mm	
Zastosowanie Application / Anwendungsbereich	profile ścienna / sufitowa – do oświetlenia wnętrz podsufitowych i aranżacji dekoracyjnych surface profiles – for the decorative and wall lighting or for the cove LED lighting / Wand-/ Deckenprofile – zur Beleuchtung von Deckennischen und Dekorationen	

Klosze (PVC/PMMA/PC) Covers / Abdeckungen

Wymiary [mm] Dimensions / Abmessungen: 1000 mm, 2020 mm, 3000 mm

TRANSPARENTNY transparent / transparent	MROŻONY frozen / frostweiß	MLECZNY milky / milchweiß	FROSTED frosted / frosted	FROSTED MLECZNY milky frosted / frosted milchweiß	LENS 15 lens 15 / lens 15	LENS 30 lens 30 / lens 30
BASIC						
✦ PMMA 95%	✦ PMMA 78%	✦ PMMA 51%	✦ PMMA 90%	✦ PMMA 83%	✦ PMMA 92%	✦ PMMA 92%
✦ PVC 88%	✦ PVC 66%	✦ PVC 44%				
✦ PC 92%	✦ PC 67%	✦ PC 36%				

MAKSYMALNA ROZPRASZANA MOC ŹRÓDŁA ŚWIATŁA LED

Maximum dissipated power of LED light sources / Maximale zerstreute Stärke von LED-Lichtquellen

DLA TEMPERATURY PROFILU

for temperature profile / für Profiltemperatur

55 °C

DLA TEMPERATURY PROFILU

for temperature profile / für Profiltemperatur

65 °C

IPA 12 / IPA 16	31,5 W	42 W
APA 12 / APA 16	32,2 W	43,4 W